

## Security hinge switches long version

### Item description/product images

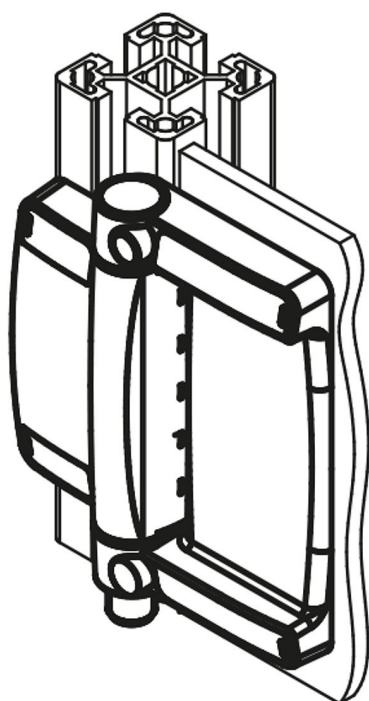

### Description

#### Material:

Housing, die-cast zinc.

Housing cover, plastic, self-extinguishing.

Hinge bolts, die-cast zinc/steel C45.

Contacts, silver-nickel alloy 10.

#### Note:

The security hinge switches are used for monitoring the position of pivoting safety doors, protective covers and protective hoods. The security is monitored directly in the hinge.

The switching angle is freely adjustable over the entire working range. A mounting aid ensures quick alignment with doors and posts.

The additional hinges have the same appearance and dimensions as the security hinge switches.

#### Application:

- Special machine construction
- Electronics industry
- Packaging machines
- Enclosures/profile systems
- Machine tools
- Measuring, processing, testing and laboratory technology

#### Assembly:

4x DIN 7984 or DIN EN ISO 4762 M6 socket head screws,

Tightening torque 4.3 Nm

General assembly instructions can be found in the accompanying operating instructions.

#### Advantages:

- Suitable for securing pivot flaps and gates
- Minimum assembly required, especially on conventional aluminium profiles
- Optimum integration into the surrounding structure
- Additional protection against tampering
- Hardly any mechanical wear

## Security hinge switches long version

### Drawings

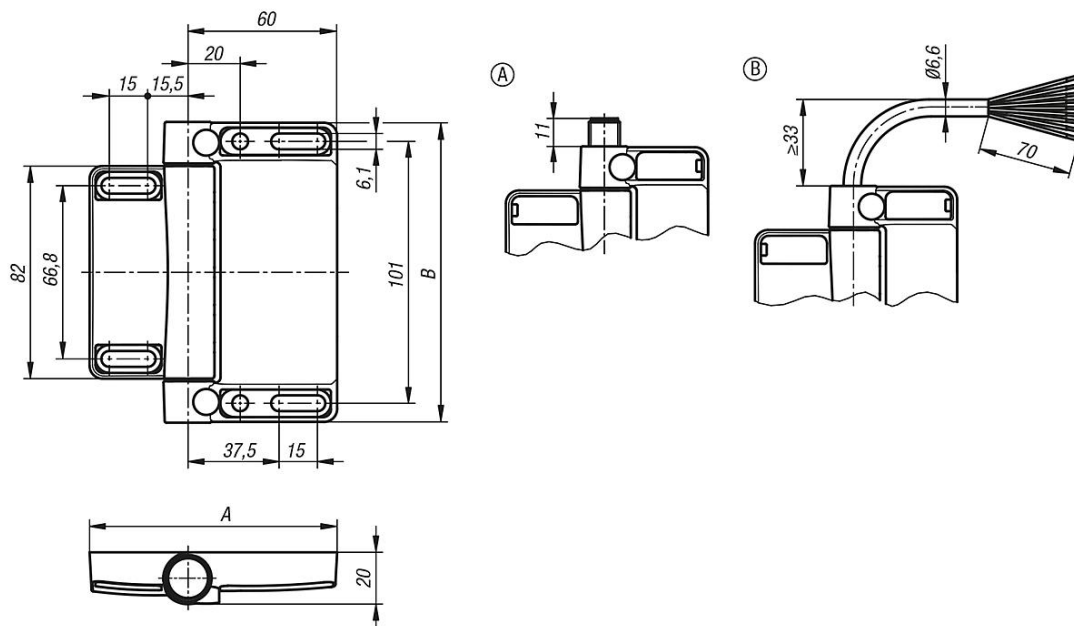

### Overview of items

#### Security hinge switches long version

Order No.	Item	Form	A	B	Default setting	Contacts	Connection type	Connection position
K1501.981161111	security hinge switch	A	98	116	external mounting	1C / 20	connector	bottom
K1501.981161112	security hinge switch	A	98	116	external mounting	1C / 20	connector	top
K1501.981162111	security hinge switch	A	98	116	universal	1C / 20	connector	bottom
K1501.981162112	security hinge switch	A	98	116	universal	1C / 20	connector	top
K1501.981161121	security hinge switch	B	98	116	external mounting	1C / 20	cable	bottom
K1501.981161122	security hinge switch	B	98	116	external mounting	1C / 20	cable	top
K1501.981162121	security hinge switch	B	98	116	universal	1C / 20	cable	bottom
K1501.981162122	security hinge switch	B	98	116	universal	1C / 20	cable	top
K1501.98116	additional hinge	-	98	116	-	-	-	-