

## Square tube connectors three-way with tapped hole

### Item description/product images



### Description

#### Material, version:

Polyamide PA, black.

Core electro zinc-plated steel.

#### Note:

No screws required. The tube connectors are simply pushed into the appropriate square tubing. They can be dismantled and reused repeatedly. For installing swivel feet, casters etc.

#### Accessory:

- Square tubes K0627
- Finned square tubes K0628

### Drawings

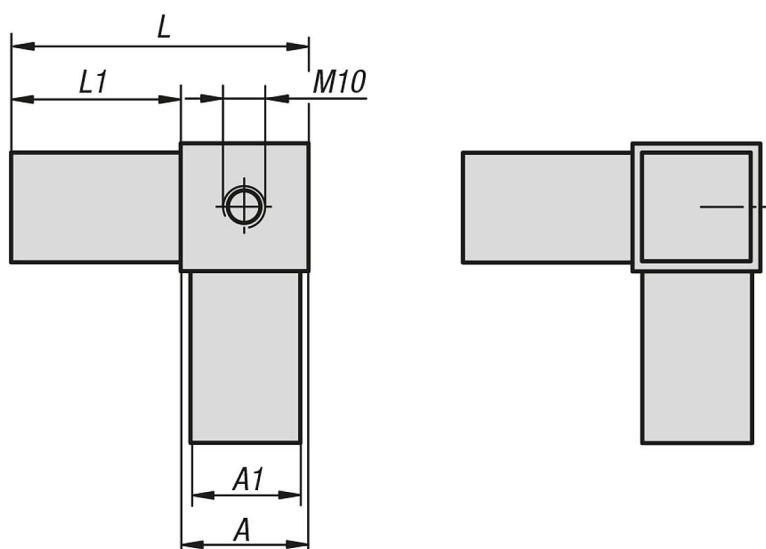

### Overview of items

## Square tube connectors three-way with tapped hole

### Overview of items

#### Square tube connectors, three-way with tapped hole

Order No.	A	A1	L	L1	Suitable for square tubes
K0623.125151210	25	22	77	52	25 x 25 x 1,5
K0623.130201210	30	26	77	47	30 x 30 x 2